



# Ford Pocket Style® Fender Flares Set of 4

Set Part #20934-02  
Rev-2 02/22/2016

For complete fitment info visit [www.bushwacker.com](http://www.bushwacker.com)

## STEP 1 – PRIOR TO INSTALLATION

- A) Bushwacker only approves installing the flares according to these written instructions with the hardware provided. WARNING: Failure to install according to these instructions will invalidate the warranty. This includes, but is not limited to using alternative installation methods, hardware, or materials. DO NOT USE: Loctite, SuperGlue, or similar products on the hardware or the flares.**
- B) Fit:** Verify the fit of the flares to vehicle. (Some filing, sanding, or cutting may be necessary to ensure proper fit).
- C) Painting:** (Optional) if paint is desired it must be done prior to installing flares on vehicle. Clean outer surface with a good grade degreaser. DO NOT USE LACQUER THINNER OR ENAMEL REDUCER AS A DEGREASER. Wipe outer surface thoroughly with a tack rag prior to paint. Application of plastic adhesion promoter for ABS plastic as per your paint system manufacturer's recommendations is required. Paint flares using a high quality enamel, or polyurethane automotive paint. If painting edge trim (not recommended), use a flex additive.
- D) Performance:** Using larger Tires may increase the area required to turn the vehicle. Some Tire/Rim combinations may require lowering bump stops and or installing steering stops to prevent tire from contacting flare.
- E) Exhaust System:** Modifications may be necessary to maintain a minimum 4" clearance between flares and exhaust pipes. (Exhaust gases should not vent directly onto flares)
- F) Metal Protection:** All exposed fasteners and bare metal should be treated with rust resistant paint BEFORE installing flares. Spray inner fender wells with undercoating AFTER flare attachments have been completed.
- G) Decals:** Flares may interfere with existing decals on vehicle. If you wish, remove decals prior to installation of flares.
- H) Care & Cleaning:** Bushwacker fender flares are built to last; any detergent you use to wash your vehicle is sufficient to clean the flare. Do not use any harsh abrasive detergents.

## TOOLS FOR EASY INSTALLATION:

- Utility Knife
- Socket Wrench
- 10mm Socket
- #2 Phillips Screwdriver
- Pry Tool
- Electric Drill

**PLEASE READ:** Dirt and debris can become lodged between the fender flares and the vehicle's fenders, causing scratching and paint wear from vibration. Lund International is not responsible for any damage, and the installation of our fender flares is done with the buyer's understanding that this scratching and paint wear may occur.

## LIMITED LIFETIME WARRANTY AGAINST ANY MANUFACTURING DEFECTS

- To claim a warranty, you must provide Proof of Purchase.

## Included in Hardware Kit:

- |   |   |   |   |   |  |   |
|---|---|---|---|---|--|---|
| 1. <br>SW1-0066,<br>#8 x 5/8" Phillips<br>PH Drill Screw,<br>4 pcs | 2. <br>SW1-0056,<br>#8 x 3/4"<br>PH Screw,<br>24 pcs           | 3. <br>CL1-0022,<br>#10 "U" Clip,<br>20 pcs                    | 4. <br>SW1-0067,<br>5/16 x 18 x 3/8"<br>SS Torx Screw,<br>27 pcs | 5. <br>NU1-0019,<br>5/16-18 Jam Fin.<br>Nylock Nut,<br>27 pcs     | 6. <br>WA1-0012,<br>.320 x .700 x .03<br>SS Washer,<br>27 pcs | 7. <br>SW1-0052,<br>T-45 Torx Bit,<br>1 pc |
| 8. <br>CL1-0001,<br>.185-.225<br>SS "U" Clip,<br>2 pcs             | 9. <br>SW1-0005,<br>1/4-20 x 3/4"<br>HxHd Slot Screw,<br>4 pcs | 10. <br>NU1-0011,<br>1/4-20 SS Serrated<br>Flange Nut,<br>4 pc | 11. <br>WA1-0005,<br>5/16" SAE Zinc<br>Flat Washer,<br>4 pcs     | 12. <br>GP1-0007,<br>Med. Wiper Style<br>Edge Trim,<br>372 inches | 13. <br>ET1-0002,<br>Edge Trim Tool,<br>1 pc                  |   |

## Component List:



## Edge Trim Installation

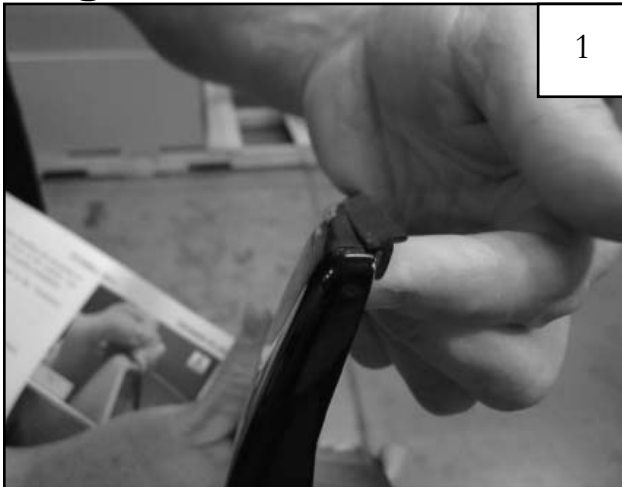

Peel two to three inches of red vinyl backing away from Edge Trim (GP1-0007) tape. Applying the adhesive side of the edge trim to the inner side of the flare, affix the edge trim to the top edge of the flare (the portion that comes in contact with the vehicle).

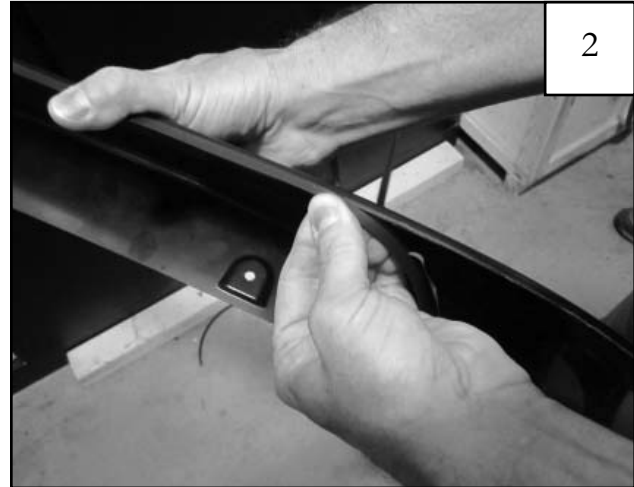

Press edge trim into place along the top edge of the flare in one-foot increments, pulling red vinyl backing free as you continue to work your way around the top edge of the flare.

(Optional):  
Apply Edge Trim to Front Bumper Piece if installing.

## Front Flare/Bumper Piece Assembly (Optional):



(Optional) Using a 5/16" bit, drill holes at indents located at the ends of Front Main and Front Bumper Pieces. Two places each part.

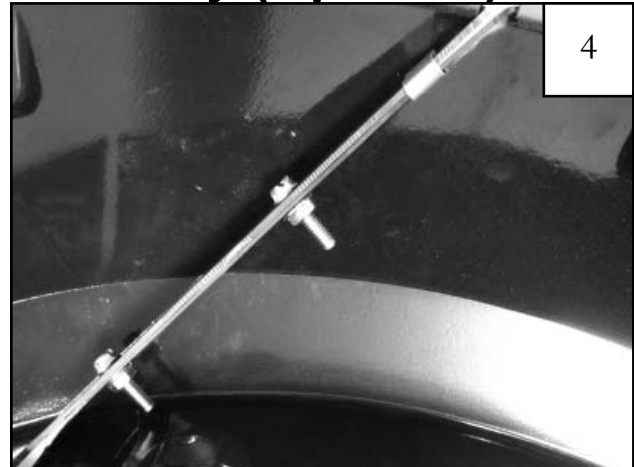

Insert the Screw/Washer assembly through the hole drilled in the end of the Front Main Flare and into the corresponding hole in the Front Bumper Piece. Two places. Install Clip CL1-0001 as close to outer edge as possible.

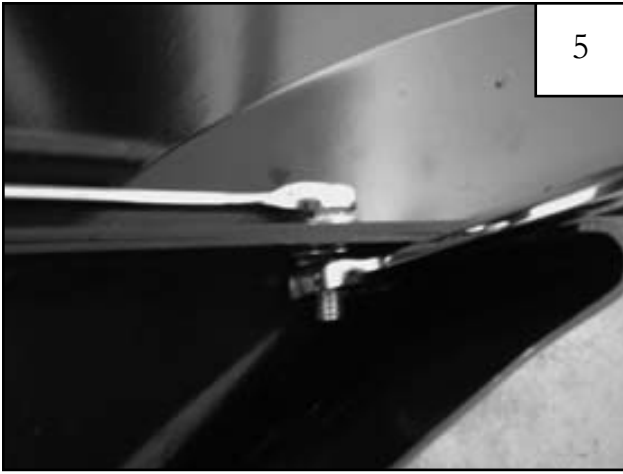

Install a supplied Nut (NU1-0011) on ends of screws and tighten

## Pocket Hardware Installation:

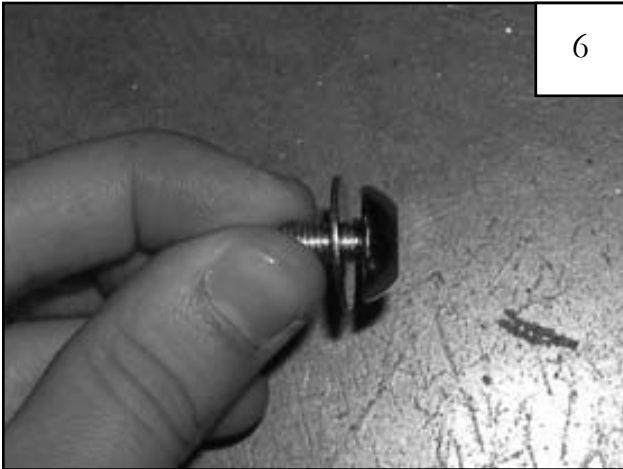

Put a Washer (WA1-0012) on each Bolt (SW1-0067).



Put each Bolt/Washer combination through a pocket hole in the flare, Bolt head and Washer on the outside.



Place a Nut (NU1-0019) over the end of each Bolt and tighten, using a 1/2" wrench for the Nut and the supplied Torx Bit (SW1-0052) for the Bolt. Repeat for remaining pockets.

# Front Flare Installation Procedures (Passenger's Side):



Using a 10mm socket remove One (1) factory bolt from under front bumper area of wheel well. Save factory bolt for reinstallation.

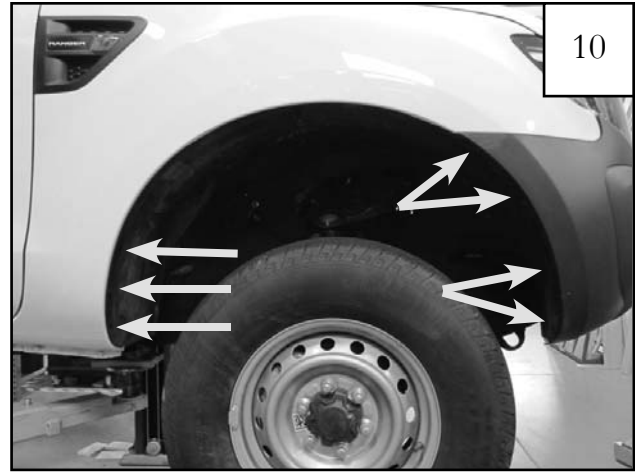

Using a Phillips Screwdriver and or pry tool, remove seven (7) factory screws/retainers from the wheel well and discard. *Note: Some vehicle models will have factory mudflaps. These will need to be removed for proper installation of flares.*



Peel back the front wheel well liner and install three (3) supplied clips (CL1-0022) at the three locations indicated. Replace liner to original position.

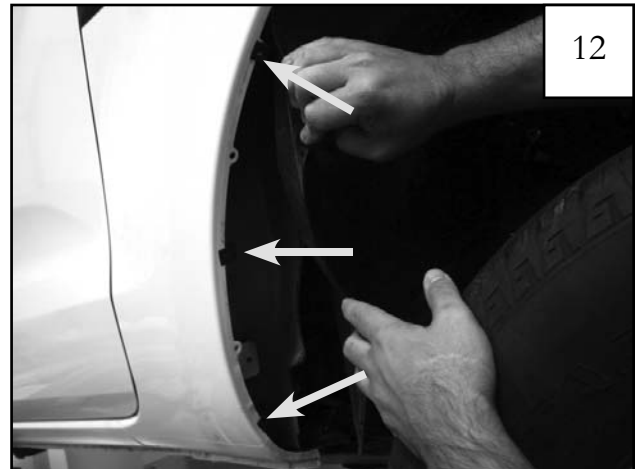

Peel back the rear wheel well liner and install three (3) supplied clips (CL1-0022) at the three locations indicated. Replace liner to original position.

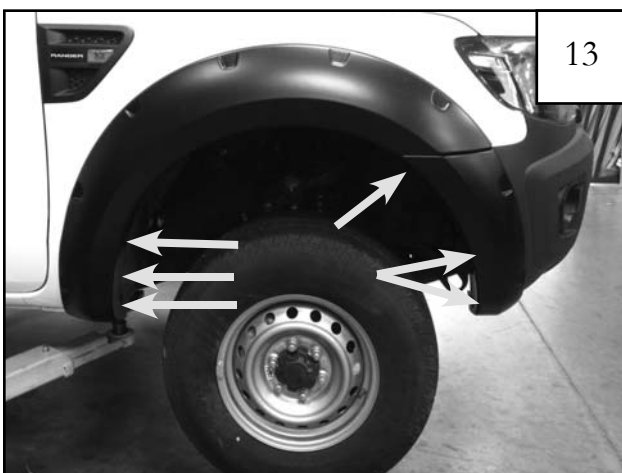

While holding Front Flare/Bumper Piece Combo on Vehicle start six (6) supplied Screws (SW1-0056) into flare and into clips installed in steps 10 & 11.



While using an electric drill install one (1) supplied self tapping screw (SW1-0066) into the center top location of flare and into sheet metal using hole in flare as a guide.



Using a 10mm socket wrench, install the factory bolt that was removed in step 8 under the front bumper area of wheel well.



Tighten all screws. Front flare installation complete.

## Rear Flare Installation Procedures (Passenger's Side):

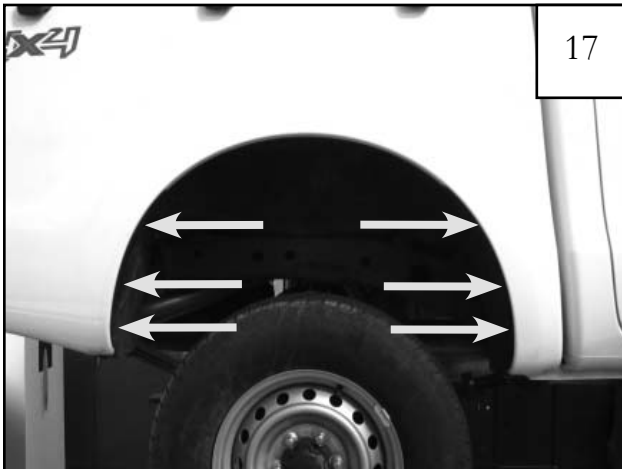

Using a #2 Phillips Screwdriver and or pry tool remove 6 pieces of factory hardware from the rear wheel well and discard. *Note: Some vehicle models will have factory mudflaps. These will need to be removed for proper installation of flares.*

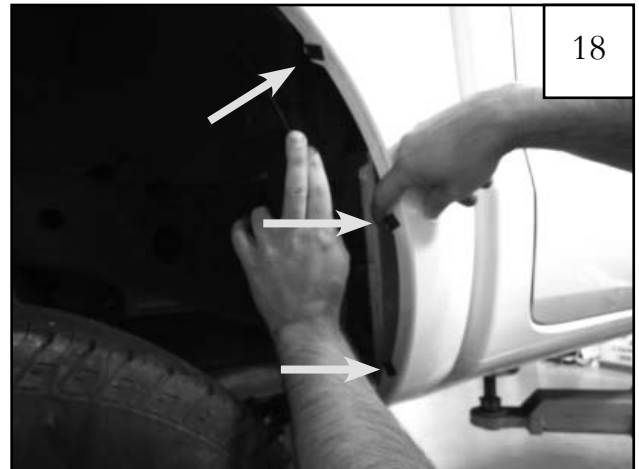

Peel back the front wheel well liner and install three (3) supplied clips (CL1-0022) at the three locations indicated. Replace liner to original position.



Peel back the rear wheel well liner and install one (1) supplied clip (CL1-0022) at the location indicated. Replace liner to original position.

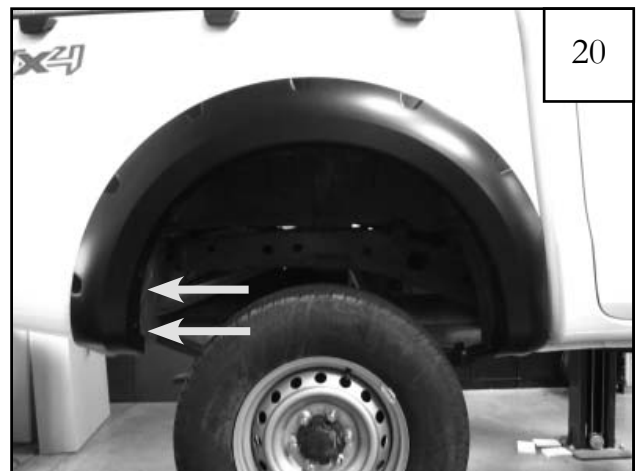

Using a #2 Phillips Screwdriver start two (2) supplied Screws (SW1-0056) thru flare and into factory hole locations using holes in flare as a guide.

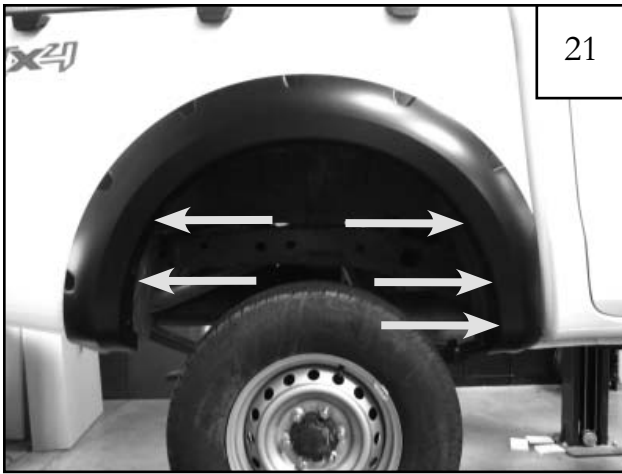

21

While holding Rear Flare onto vehicle using a #2 Phillips Screwdriver, start six (6) supplied Screws (SW1-0056) into flare and into clips installed in steps 17 & 18.

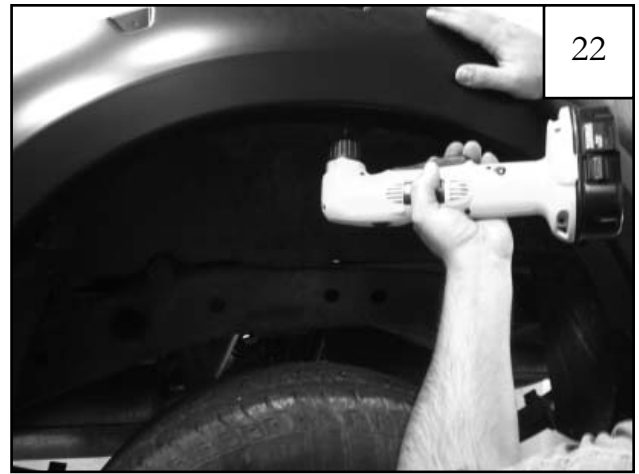

22

While using an electric drill install one (1) supplied self tapping screw (SW1-0066) into the center top location of flare and into sheet metal using hole in flare as a guide.



23

Tighten all screws. Rear flare installation complete.

## Edge Trim Tool Procedures:

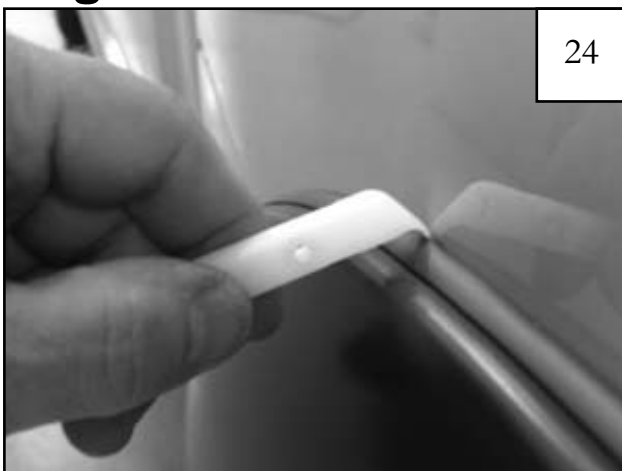

24

Using supplied Edge Trim Tool (ET1-0002), seat edge trim against vehicle by hooking curved end under edge trim at one end of flare. Next, slide around outer edge of flare to the other end.



25

Using flat end of supplied Edge Trim Tool (ET1-0002), seat edge trim against flare by inserting straight end between edge trim and flare at one end. Next, slide around entire edge to the other end.